

Reducing Nut Adaptors

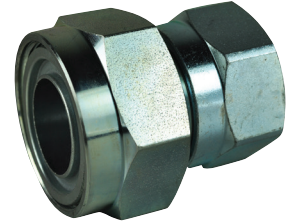

Benefits:

- Leak free o-ring seal
- Safe joint every time
- Low tightening torque and clamping force rises with the internal pressure.
- Low installed cost, no welding (so inert gas purging, NDT and excessive flushing are not required), minimal tube preparation and no special assembly equipment required.
- Demountable and reusable, can be used with most tube materials.



Features:

Body- mild steel, compatible with most fluids and environments. Locates O'ring and tube.

O ring- nitrile, compatible with most fluids, highly resistant to leakage even under severe vibration, pressure pulsation and temperature cycling. Provides diametric seal between the O/D and body cavity.

Nut- mild steel, compatible with environments. Closes split collet and retains sealing mechanism.

Back-up washer- mild steel. Provides additional support for the tube and locates the O ring.

Split collet- mild steel. Clamping force rises with pressure. Large clamping area ensures minimal deformation of the tube. Retains tube in position.

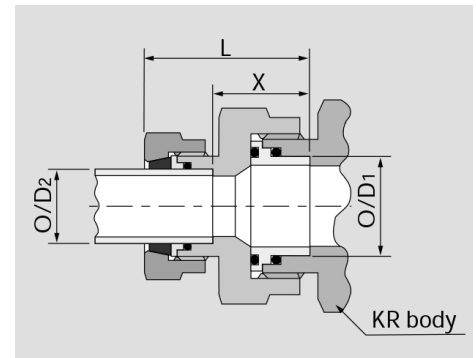

All fittings also available in the following materials upon request:

- Stainless steel
- Cupro-nickel

Seals available on request:

- EP (ethylene propylene)
- FEP encapsulated FPM

All fittings supplied with Nitrile seals as standard.

Tube x Female			
0459	OD mm	OD mm	£
KRAM10-M6RNR	10	6	17.70
KRAM10-M8RNR	10	8	17.90
KRAM12-M8RNR	12	8	15.55
KRAM12-M10RNR	12	10	17.90
KRAM16-M8RNR	16	8	16.85
KRAM16-M12RNR	16	12	16.70
KRAM20-M10RNR	20	10	20.95
KRAM20-M12RNR	20	12	20.55
KRAM20-M16RNR	20	16	20.35
KRAM25-M12RNR	25	12	30.90
KRAM25-M16RNR	25	16	29.35
KRAM25-M20RNR	25	20	29.00
KRAM30-M25RNR	30	25	30.40
KRAM38-M20RNR	38	20	65.30
KRAM38-M25RNR	38	25	47.70
KRAM38-M30RNR	38	30	55.20
KRAM50-M25RNR	50	25	53.05
KRAM50-M30RNR	50	30	154.15
KRAM50-M38RNR	50	38	89.15

O/D mm		Part No	Dimensions - mm		Nut	
1	2		L	X	1	2
8	6	AM8-M6RNR	35	18	17	16
10	8	AM10-M8RNR	39	24	17	27
10	6	AM10-M6RNR	39	24	16	27
12	10	AM12-M10RNR	43	21	27	27
12	8	AM12-M8RNR	39	24	17	27
12	6	AM12-M6RNR	39	24	16	27
16	12	AM16-M12RNR	43	21	27	32
16	10	AM16-M10RNR	43	21	27	32
16	8	AM16-M8RNR	40	25	17	32
16	6	AM16-M6RNR	40	25	16	32
20	16	AM20-M16RNR	52	28	32	41
20	12	AM20-M12RNR	50	28	27	41
20	10	AM20-M10RNR	50	28	27	41
25	20	AM25-M20RNR	58	28	41	46
25	16	AM25-M16RNR	53	29	32	46
25	12	AM25-M12RNR	51	29	27	46
30	25	AM30-M25RNR	61	29	46	50
30	20	AM30-M20RNR	58	28	41	50
30	16	AM30-M16RNR	53	29	32	50
38	30	AM38-M30RNR	70	36	50	60
38	25	AM38-M25RNR	67	36	46	60
38	20	AM38-M20RNR	66	36	41	60
50	38	AM50-M38RNR	86	48	60	80
50	30	AM50-M30RNR	82	49	50	80
50	25	AM50-M25RNR	79	49	46	80